

2 Bedroom

Plot Type 4F

Wells House
Plot 91, 95, 99

Dimensions

Kitchen/Living/Dining
7.85m x 4.60m 25'9" x 11'9"

Principal Bedroom
4.20m x 3.30m 13'9" x 10'9"

Bedroom 2
3.80m x 2.90m 12'5" x 9'6"

Balcony 1
3.45m x 1.10m 11'3" x 3'7"

Balcony 2
3.45m x 1.10m 11'3" x 3'7"

Total Area
67.4 sq m 725 sq ft

Block plan

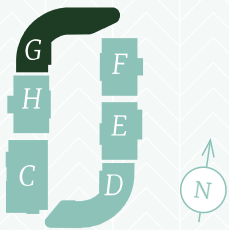

Floor locator

8	
7	
6	
5	
4	
3	99
2	95
1	91
GF	



Key

C	Cupboard
W	Wardrobe

Maximum dimensions are shown.
They are intended as a guide only and are subject to change.
Not all plans are to scale.
Please speak to our sales executive for further information.